

Smart Home IoT Kits

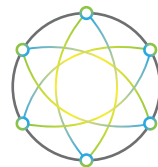

Air Live
Smart Life IOT
For Home



© 2017 OvisLink Corporation, All Rights Reserved

Information and Disclaimer:

OvisLink Corp. has made the best effort to ensure the accuracy of the information in this catalog. However, we are not liable for errors or inaccuracies of this guide. All information is subject to change without notice.

All trademarks and trade names are properties of their respective holders.

www.airlive.com

OvisLink Corp.

5F, No.6, Lane 130, Min-Chuan Rd., Hsin-Tien Dist.,
New Taipei City 231, Taiwan
TEL: +886 2218 6888 E-mail: info@airlive.com



Build up Your Smart Life



Gateway



3 in 1
Sensor



PIR Motion
Sensor

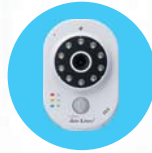

Smart
IPCam



Smart
Plug

AirLive Smart Life IoT Kit provides you a whole new lifestyle of home security, convenience, and energy saving.

You can use our IoT APP to control all AirLive IoT devices from your smartphone wherever you are.



Control Anywhere

AirLive Smart Life IoT Kit is equipped with P2P technology and is easy to control. With AirLive IoT APP, you can Live View the camera's image, turn on/off the devices which are plugged into the Smart Plug and check the status of your home anywhere.



Why use Z-wave?

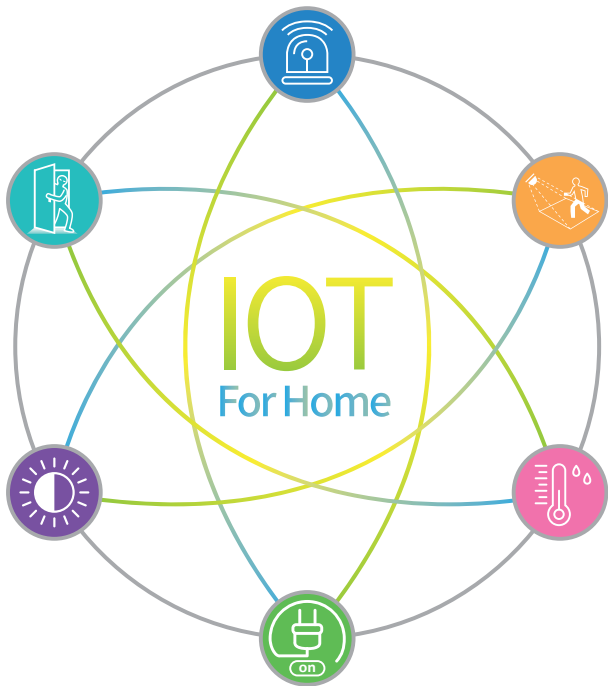

AirLive IoT Kit follows the Z-wave protocol, which is a powerful standard with the advantages of low power, great stability, interoperability and longer wireless distance.

Easy to Install

1 Install Gateway



2 Download APP



3 Install Sensor



4 Start to use



Smart Home Kit

Users only need to connect the Gateway to Internet and download AirLive Smart Life IoT APP. After this you can install other devices and control them easily from any location.

Build up Your Home Security

AirLive IoT Kit assists you to build up your home safety system. When a thief is trying to break into your house, the 3 in 1 (door/window) Sensor and PIR Motion Sensor will be triggered. At the same time, the siren in the Gateway will turn on as warning and the Gateway will also send a notification to your smartphone, so you can know what is going on; immediate Live View is also possible with the Smart IP cam.

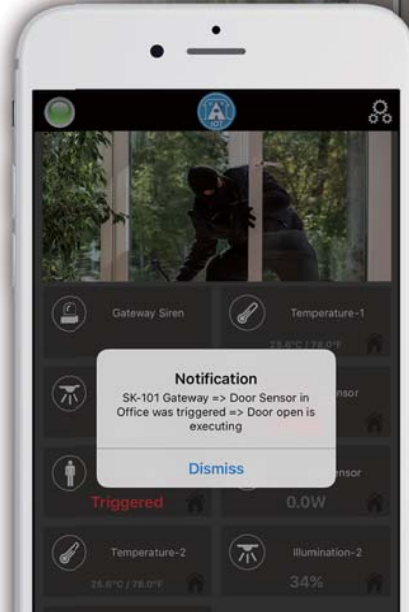
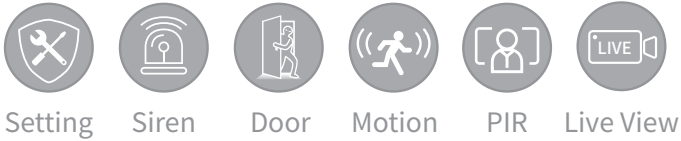
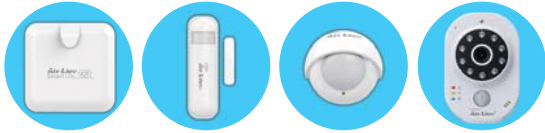

Family Care

When children or elders are staying alone at home, the Live View function can help you to check if any accident has happened, and then you can handle the situation directly.

Beside this, when they are going to the toilet at night, it will be safer for them if the light will be turned on automatically. This can be done by AirLive IoT Kit. When someone is approaching the PIR Motion Sensor, then the Smart Plug will turn the light on, so they will not walk in the dark.



Setting

Power
on/off

Door

PIR

Motion





Energy saving

AirLive Smart Plug has a built-in feature of energy measurement. It will help you to identify the most energy-hungry electrical devices in your home, and let you know how much electricity the device is consuming. Therefore, it is useful for controlling the energy consumption in your house with our Smart Plug.



Setting Illumination Temperature Power Usage Power on/off



80W



210W



550W



1250W



2000W



2300W

AirLive Smart Life IoT offers three different packages which you can use to build up your own smart life effortlessly.



Package Choose

SK-101



SK-102



SK-103





Gateway (SG-101)

The compact Smart Life Gateway is the heart of smart home. It comes with a built-in 6 tones siren and 802.11n wifi. Very easy setup via the mobile APP, no computer is needed.



Siren

Setting

- *Z-wave plus
- *Peer to Peer (P2P) technology
- *Wall mountable
- *IEEE 802.11n AP mode
- *1 X LAN Port
- *High security level with 128 bit AES encryption
- *Siren (6 tones, 110db)
- *Up to 60 meter
- *Up to 232 Z-wave devices

3 in 1 Sensor (SI-101)

It is not only a door/window contact but also has a built-in temperature and light sensor. Setup multiple scenarios in your home.

- *Z-wave plus
- *Temperature/Door&Window/Light sensor
- *Low power consumption
- *Tamper proof protection
- *Battery Life 2 years



Temperature



Door



Illumination

PIR Motion Sensor (SI-102)

Small compact and easy to install, the AirLive Smart Life PIR Motion Sensor can be placed at almost any location with its magnet mounting cradle.

- *Z-wave plus
- *Max. 8 meter motion detection distance
- *140 degree motion detection angle
- *Angle adjustable and wall mountable
- *Tamper proof protection
- *Battery Life 2 years



PIR



Motion



Live View



WiFi

Smart IPCam (Smart Cube 300W)

The SC-300W Smart Cube Camera is a multi-function camera which not only has 3MP, but also a PIR, temperature and humidity sensor build inside. With its IR leds and ICR clear night vision is also possible.

- *1/3" 3MP CMOS Sensor
- *3MP (2048x1536) Resolution
- *15M IR Distance
- *Build-in ICR, Speaker, Microphone
- *802.11n, 10/100 LAN
- *Micro SD card slot
- *5V/1A power



Power Usage



Power on/off



Repeater

Smart Plug (SP-101)

The Smart Plug with power measurement function is design for your home. It can turn on/off any devices directly from your smartphone and see the energy consumption.

To extend distance, the Smart Plug can also work as a repeater.

- *Z-wave plus
- *Up to 3000W resistive load or 320W for fluorescent load
- *Overload protection
- *Auto report the power usage
- *Longer Z-wave signal transmission
- *Automatic Z-wave signal repeater

Socket Type



FR



DE



US



UK

